



EVAARAH



SCAN QR CODE FOR LOCATION

For More Details Contact: **958 750 6507**

Corporate Address: 5A/5D, Corporate Tower A-2,
Near Jawahar Circle, JLN Marg, Jaipur, Rajasthan-302017



   ashadeep.group

evaarah.ashadeepgroup.com
ashadeepgroup.com



RERA Reg. No.: RAJ/P/2026/4706
RERA Website: www.rera.rajasthan.gov.in

DISCLAIMER: This communication is for representational and conceptual purposes only and does not constitute an offer, promise, or contractual obligation by the Developer. All plans, layouts, specifications, visuals, dimensions, amenities, and details are indicative and subject to change at the sole discretion of the Developer and/or architects, in accordance with applicable laws. Internal dimensions are measured from brick to brick, and balcony sizes are up to the outer edge of the slab; minor variations may occur during construction. The built-up and super built-up areas are provided solely for comparison with similar products in the industry. Block and unit numbering are for marketing purposes and must be read in conjunction with approved layouts.

A close-up photograph of a hand using a carving tool to create a detailed wooden relief. The relief features a pine cone and various leaves, rendered with intricate detail. The background is dark, and the lighting highlights the texture of the wood and the hand. The overall color palette is warm and monochromatic, dominated by shades of brown and tan.

WELCOME TO
*Bani Park's Finest Residences,
Designed For Privacy.*



23+
Years

of building trust

46
Projects

delivered

8500+
Families

living across Ashadeep communities

6,96,925
Sq.M.

of plotted development delivered

130
Lacs+ Sq.Ft.

of residential & commercial spaces built



The World Street (Jaipur)

READY FOR YOU IN 2028

Floors : G+8
Units : 276
Land Area : 5.43 Acres (Approx)



Ananta Jagat (Bhiwadi)

COMPLETED IN 2017

Floors : G+14
Units : 306
Land Area : 7.84 Acres (Approx)



Green Acres (Neemrana)

COMPLETED IN 2019

Floors : G+1, G+2, G+6, G+9
Units : 1349
Land Area : 56.31 Acres (Approx)



King's Court (Jaipur)

COMPLETED IN 2019

Floors : G+1
Units : 116
Land Area : 4.6 Acres (Approx)



Upvan (Behror)

COMPLETED IN 2023

Floors : G+1, G+2, G+4
Units : 2536
Land Area : 28.51 Acres (Approx)



Vedanta (Jaipur)

PHASE-1 - COMPLETED IN 2019
PHASE-2 - COMPLETED IN 2025
PHASE-3 - READY FOR YOU IN 2028

Floors : G+6, G+12
Units : 269+102+216
Land Area : 8.06 Acres (Approx)



Rainbow (Jaipur)

COMPLETED IN 2022

Floors : G+12 & G+1
Units : 576
Land Area : 5.97 Acres (Approx)

Bani Park's Finest

A considered collection of private residences designed for those who value space, calm and discretion. Rooted in central Bani Park, yet thoughtfully set apart.



SCAN FOR GOOGLE LOCATION



EVAARAH

ONLY 66 RESIDENCES, BY DESIGN.



4 & 5 BHK PRIVATE RESIDENCES

At the heart of Bani Park, Evaarah is a low-density address crafted for space, calm and comfort. Each home features expansive living areas, with a thoughtful layout that clearly separates private and service zones. This design ensures better privacy, while allowing natural light, fresh air and everyday living to flow effortlessly.





THE PRIVATE GREEN WITHIN

Set at the heart of Evaarah, yet gently removed from the city beyond.

This central green allows air and sunlight to move freely through each home. Windows open to softer, greener views. Children play within the comfort of sight.

It creates distance from noise. And brings daily life closer to calm.

Not just a landscaped space. A quieter way of living.







THE TERRACE COLLECTION

A Limited Collection Of Just 10.

Homes on the sixth floor come with private staircases
that lead to their own terrace—an extension of living, above it all.
An upper level open to the sky, designed for quiet moments and personal space.
A rare offering, reserved for a select few within Evaarah.



CLUB 66

*14,000 Sq. Ft. of elevated club living, spread across stilt,
basement and rooftop*



SWIM ABOVE THE CITY

A calm rooftop retreat with open views and space to unwind.
Perfect for a refreshing swim or a quiet pause above the city.

ACTIVE & SOCIAL LIVING

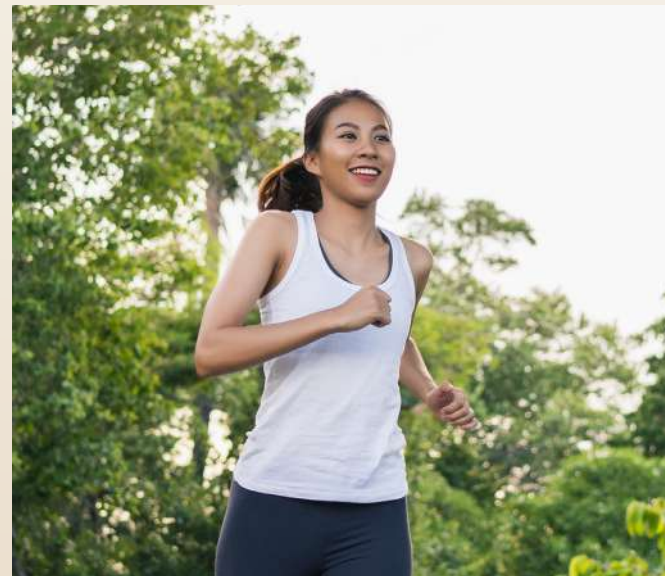

Swimming Pool | Gymnasium | Yoga Room | Dance & Zumba Studio
Jogging Track | Pickleball Court | Indoor Games Area | Kids' Play Area

COMFORT, WORK & LEISURE

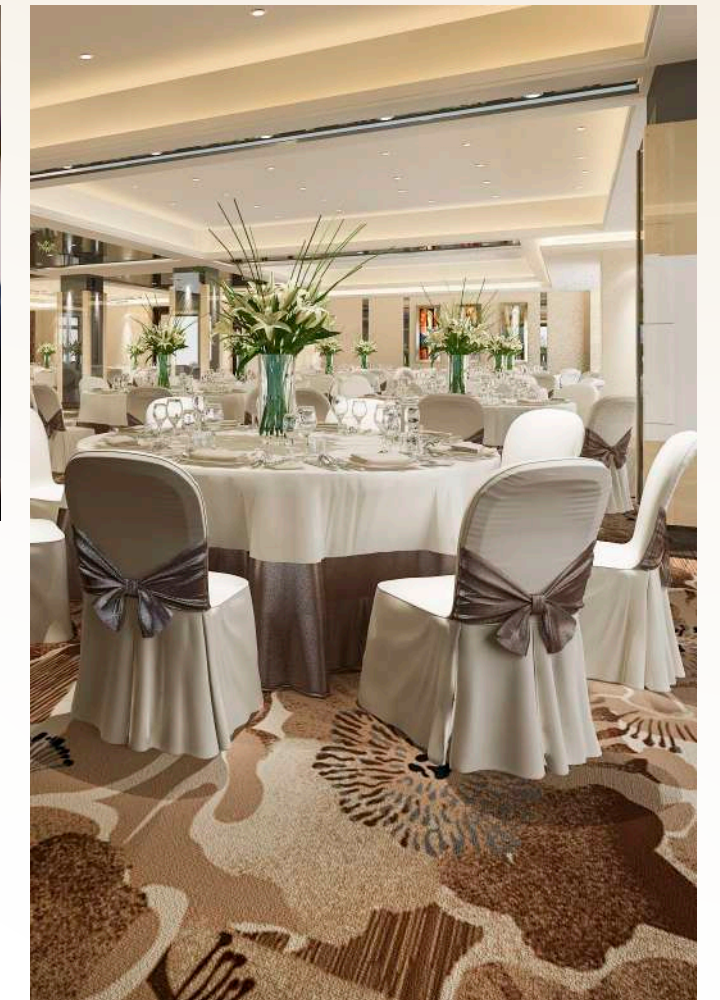

Reception & Waiting Lounge | Co-working Area
Library | Mini Theatre | Multipurpose Hall | Guest Rooms



FLOOR PLANS

*Thoughtfully designed layouts that balance space, light, and functionality
for everyday living.*



STILT FLOOR PLAN

LEGEND

- A** Parking
- B** Playground & Sitting Area
- C** Private Offices
- D** Conference Room
- E** Work Stations
- F** Entrance Lobby
- G** Mini Theatre
- H** Indoor Games Area
- I** Gym
- J** Dance & Zumba Studio
- K** Yoga Room
- L** Changing Rooms
- M** Multipurpose Hall
- N** Society Office
- O** Library
- P** Kid's Play Area
- Q** Guest Rooms



TOWER-D

TOWER-C

TOWER-E

TOWER-F

TOWER-B

TOWER-A

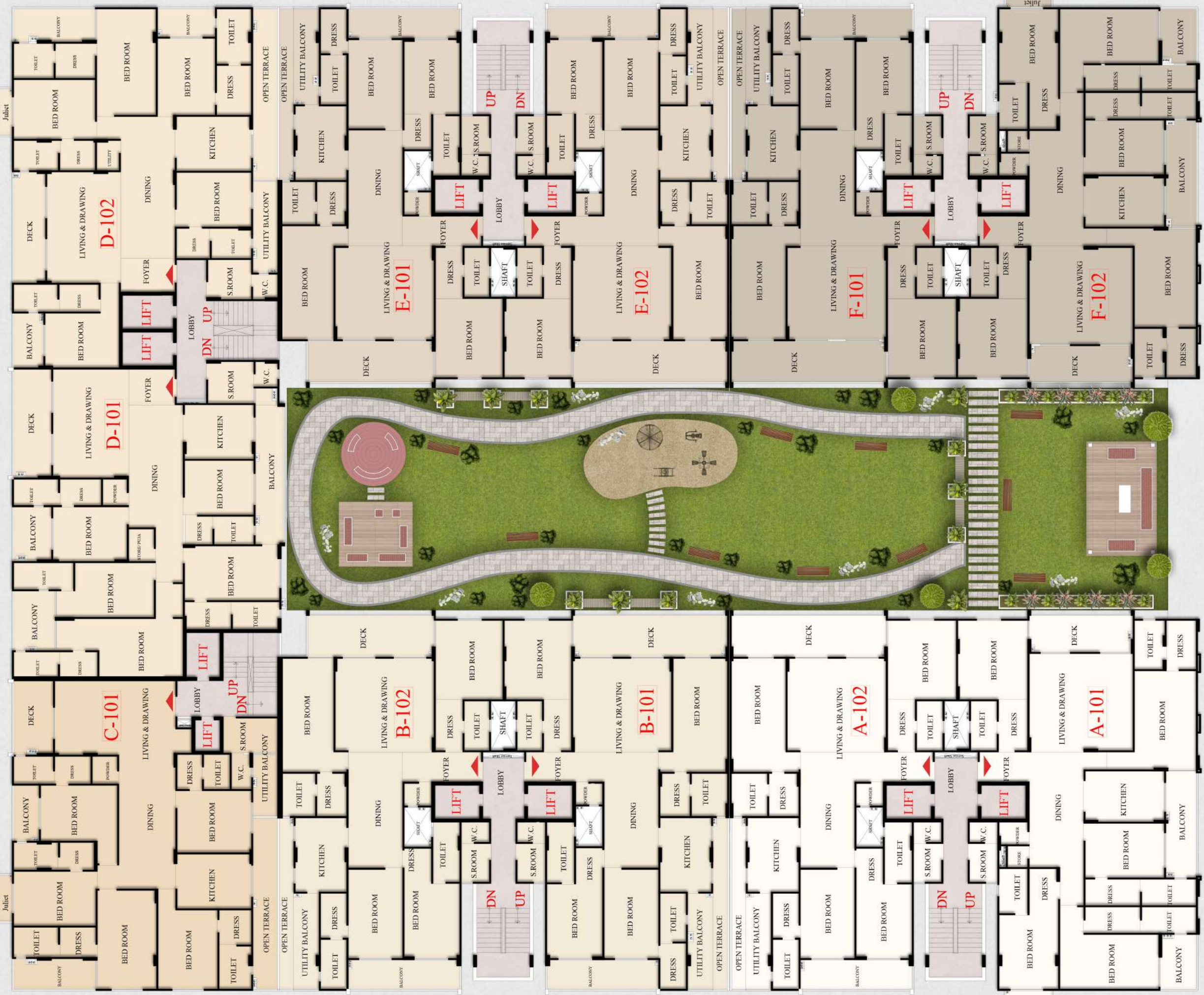

ROAD (SHIV MARG) 50'-0" WIDE

1ST FLOOR PLAN

UNIT NO.

A-101	A-102
B-101	B-102
C-101	
D-101	D-102
E-101	E-102
F-101	F-102





TOWER-D

TOWER-C

TOWER-E

TOWER-F

TOWER-B

TOWER-A

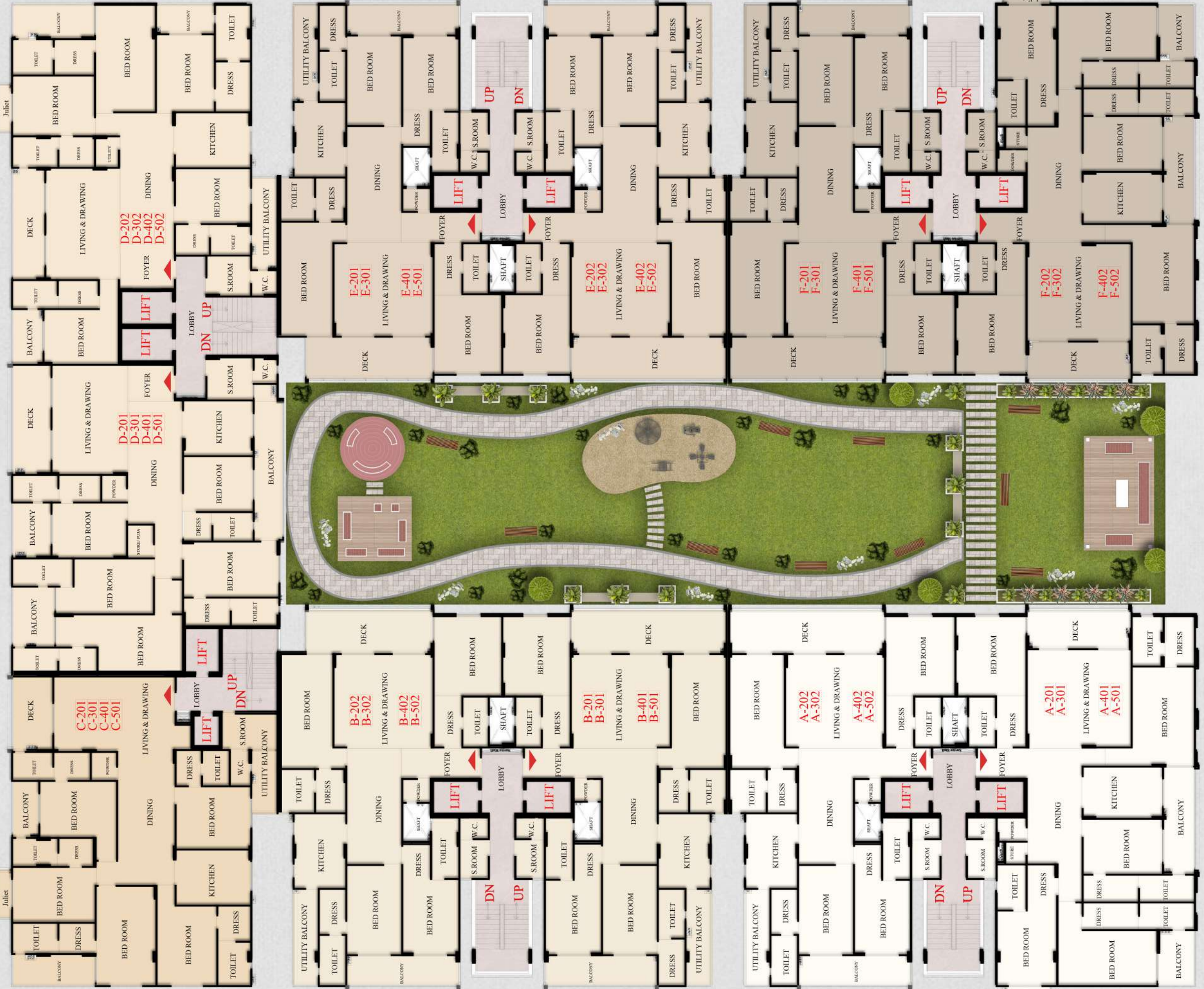

ROAD (SHIV MARG) 50'-0" WIDE

2ND TO 5TH FLOOR PLAN

UNIT NO.

A-201, 301, 401, 501	A-202, 302, 402, 502
B-201, 301, 401, 501	B-202, 302, 402, 502
C-201, 301, 401, 501	
D-201, 301, 401, 501	D-202, 302, 402, 502
E-201, 301, 401, 501	E-202, 302, 402, 502
F-201, 301, 401, 501	F-202, 302, 402, 502



6TH FLOOR PLAN

UNIT NO.

A-601	A-602
B-601	B-602
C-601	
D-601	D-602
E-601	E-602
F-601	F-602

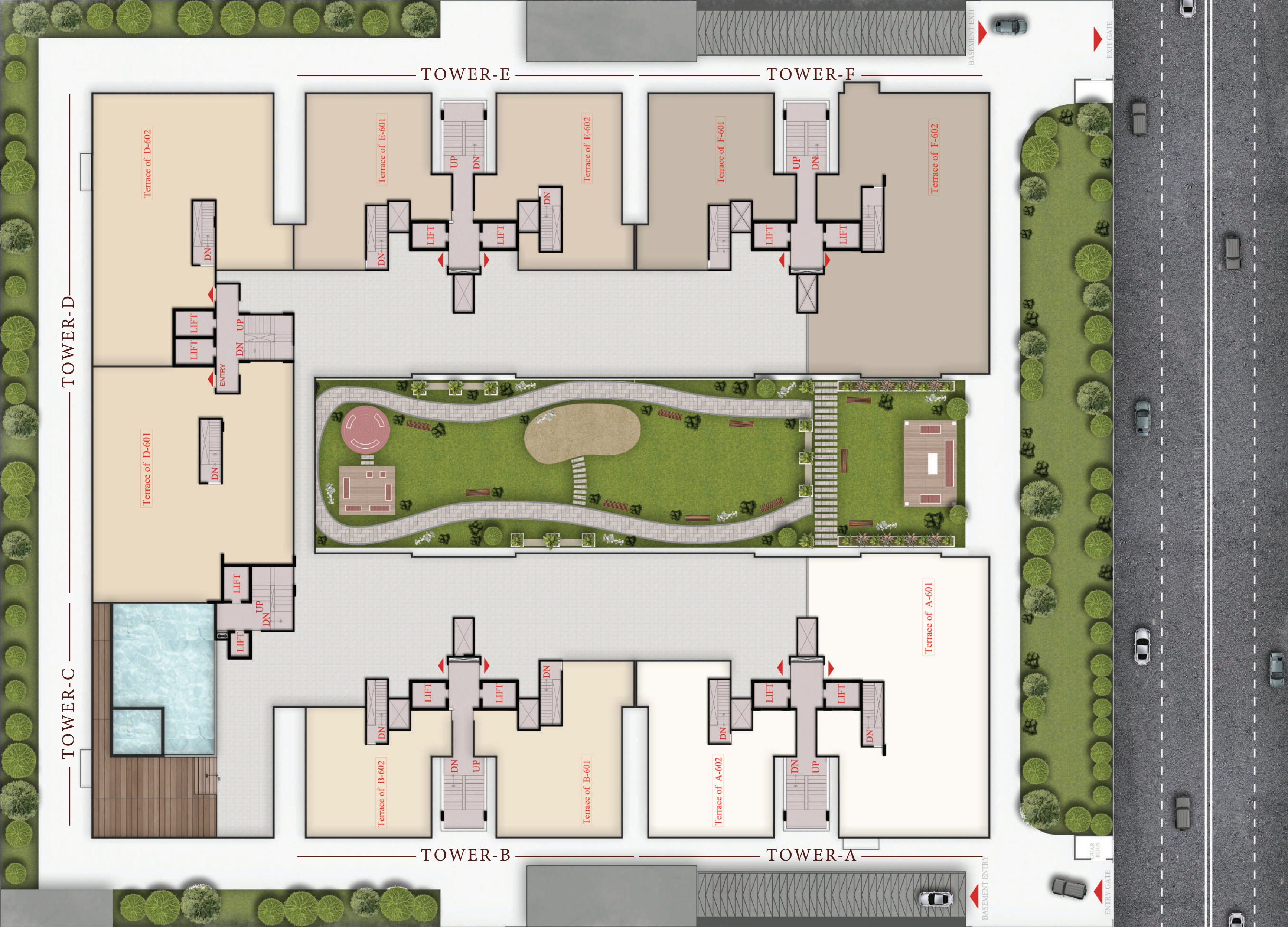

TERRACE PLAN

UNIT NO.

A-601	A-602
B-601	B-602
D-601	D-602
E-601	E-602
F-601	F-602

PROJECT SPECIFICATIONS*

Security Automation	Automatic Boom barriers on Entry & Exit Gate Intercom terminal from main gate and CCTV All Lifts with Automotive Rescue Device (ARD) All lifts are Gearless															
Lift Lobby	Well designed lift lobby Flooring: Marble / Granite / Tile															
Electrical	15 KVA Power Back-up in each flat Full power backup for common area															
Water & Waste Water Management	Water supply system Rain water harvesting for ground water recharge Sewerage Treatment Plant (STP) Recirculation of treated water for flushing and gardening Common water softner plant															
Other Facilities	Ample open and landscaped area															
Club	<table> <tr> <td>-Swimming Pool</td> <td>-Table Tennis</td> <td>-Library</td> </tr> <tr> <td>-Gymnasium</td> <td>-Pickleball Court</td> <td>-Multipurpose Hall</td> </tr> <tr> <td>-Yoga Room</td> <td>-Billiards Table</td> <td>-Co-working Area</td> </tr> <tr> <td>-Mini Theatre</td> <td>-Board Games</td> <td>-Kid's Play Area</td> </tr> <tr> <td>-Guest Rooms</td> <td></td> <td>-Dance & Zumba Studio</td> </tr> </table>	-Swimming Pool	-Table Tennis	-Library	-Gymnasium	-Pickleball Court	-Multipurpose Hall	-Yoga Room	-Billiards Table	-Co-working Area	-Mini Theatre	-Board Games	-Kid's Play Area	-Guest Rooms		-Dance & Zumba Studio
-Swimming Pool	-Table Tennis	-Library														
-Gymnasium	-Pickleball Court	-Multipurpose Hall														
-Yoga Room	-Billiards Table	-Co-working Area														
-Mini Theatre	-Board Games	-Kid's Play Area														
-Guest Rooms		-Dance & Zumba Studio														
Structure	Earthquake Resistance Structure as per norms															
Fire Fighting System	As per norms															
Common Area Maintenance	As per Apartment Act															

UNIT SPECIFICATIONS*

Washrooms	Fully finished washrooms with vitrified wall tiles up to ceiling height, fitted with premium CP and sanitary fittings from reputed brands like Toto, Roca or equivalent, Glass partition for bath area.
Doors	Main doors are 50 mm thick, ensuring sturdiness and durability, while internal doors are 35 mm thick for a refined finish.
Windows	3-track aluminium powder-coated windows equipped with mosquito mesh for enhanced ventilation and comfort.
Flooring	Premium Italian marble flooring in all bedrooms, drawing room, dining area, and kitchen.
Kitchen	Fully equipped modular kitchen with marble partitions and quartz platform top, including hob, chimney, microwave, OTG oven, double-door refrigerator, geyser, dishwasher and RO.
Air Conditioning	AC piping provision provided.

*Specifications are subject to change as per agreed terms.



EVAARAH



B E C A U S E S O M E A D D R E S S E S
A R E N ' T M E A N T T O B E F O U N D

They're Meant To Be Chosen.